



Manuel d'installation

STAGE3 607C
STAGE3 607CF
STAGE3 427
STAGE3 427F
STAGE3 527

STAGE3 527F
STAGE3 627
STAGE3 627F
STAGE3 637F
STAGE3 6427

STAGE3 8627
STAGE3 9637
STAGE3 9637F

STAGE3 607C

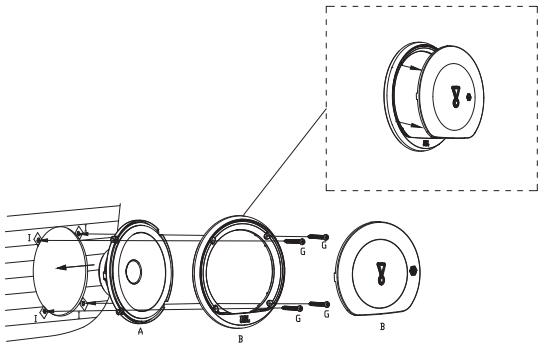

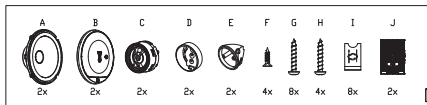
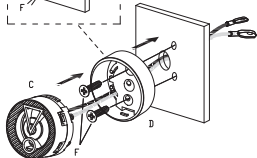
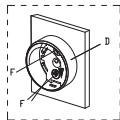
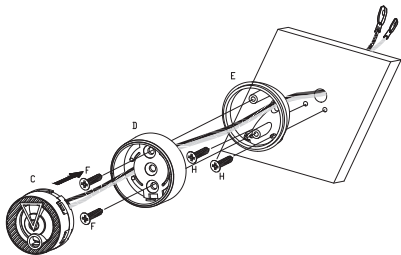

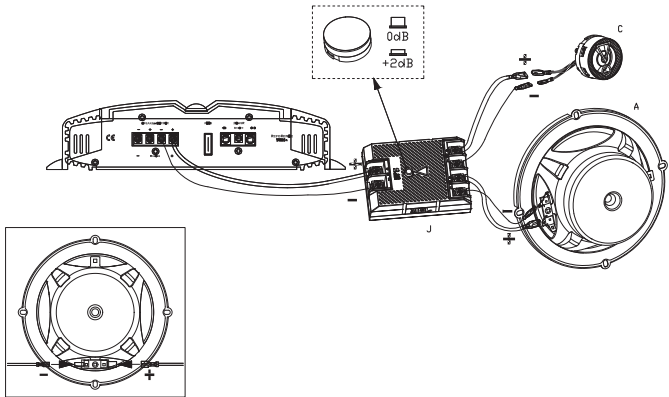

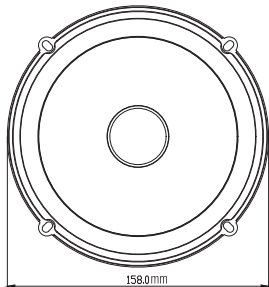
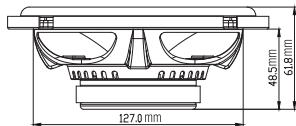
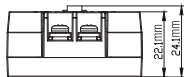
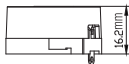
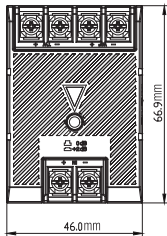

Spécifications

- Type: Système de haut-parleur de voiture 2 voies de 165 mm
- Tenue en puissance : 50 W RMS, 250 W maximum
- Sensibilité (à 2,83 V/1 m) : 92 dB
- Réponse en fréquence : 55 Hz – 20 kHz
- Impédance : 3 ohms

Paramètres de Thiele-Small

- BL (Tm): 3.316
- DCR (ohms): 2.45
- Mms (g): 14.017
- Sd (cm²): 138.93
- Cms (µm/N): 0.316
- Vas (l): 8.6375
- Fs (Hz): 75.6
- Qes: 1.482
- Qms: 11.842
- Qts: 1.317
- Crossover Point: 5kHz

STAGE3 607CF

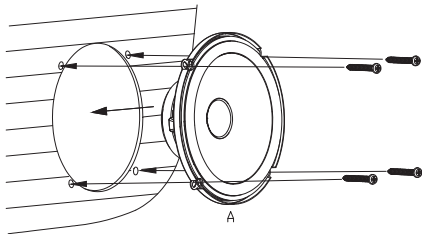

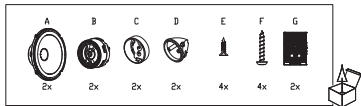
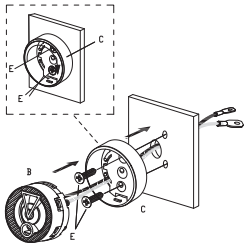
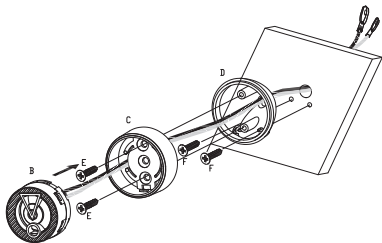

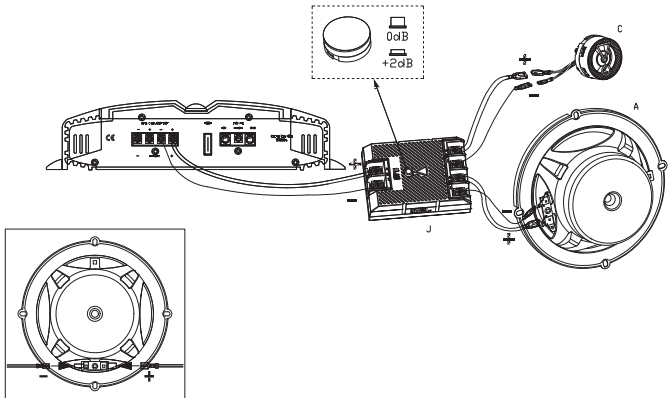

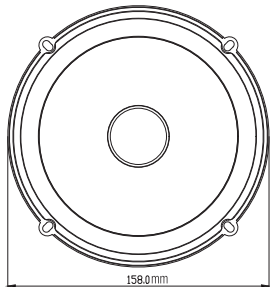
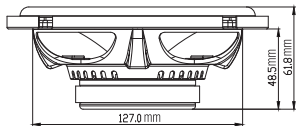
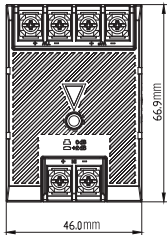

Spécifications

- Type: Système de haut-parleur de voiture 2 voies de 165 mm pour optimisation du système d'origine sans grille
- Tenue en puissance : 50 W RMS, 250 W maximum
- Sensibilité (à 2,83 V/1 m) : 92 dB
- Réponse en fréquence : 55 Hz – 20 kHz
- Impédance : 3 ohms

Paramètres de Thiele-Small

- BL (Tm): 3.316
- DCR (ohms): 2.45
- Mms (g): 14.017
- Sd (cm²): 138.93
- Cms (µm/N): 0.316
- Vas (l): 8.6375
- Fs (Hz): 75.6
- Qes: 1.482
- Qms: 11.842
- Qts: 1.317
- Crossover Point: 5kHz

STAGE3 427

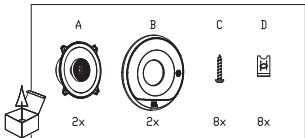
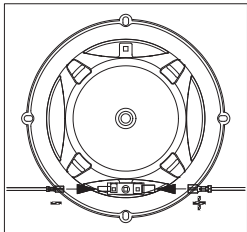
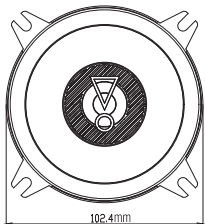
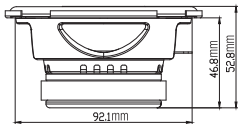

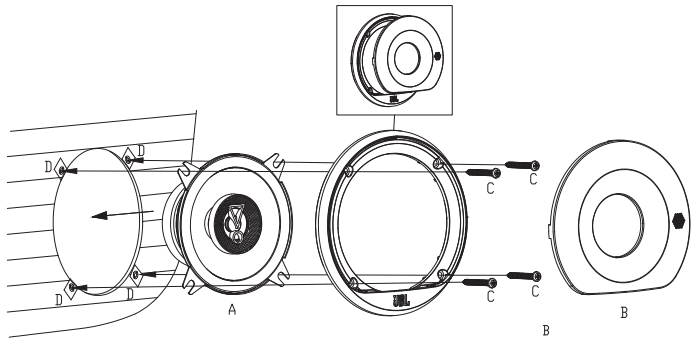

Spécifications

- Type: Haut-parleur de voiture coaxial
2 voies de 100 mm
- Tenue en puissance : 30 W RMS, 150 W maximum
- Sensibilité (à 2,83 V/1 m) : 90 dB
- Réponse en fréquence : 75 Hz – 20 kHz
- Impédance : 3 ohms

Paramètres de Thiele-Small

- BL (Tm): 2.467
- DCR (ohms): 2.74
- Mms (g): 5.501
- Sd (cm²): 63.62
- Cms (µm/N): 0.387
- Vas (l): 2.2146
- Fs (Hz): 109.1
- Qes: 1.698
- Qms: 12.973
- Qts: 1.501
- Crossover Point: 7kHz

STAGE3 427F

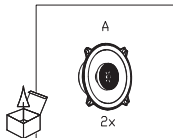
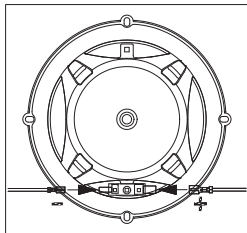
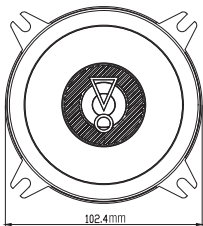
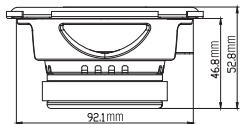

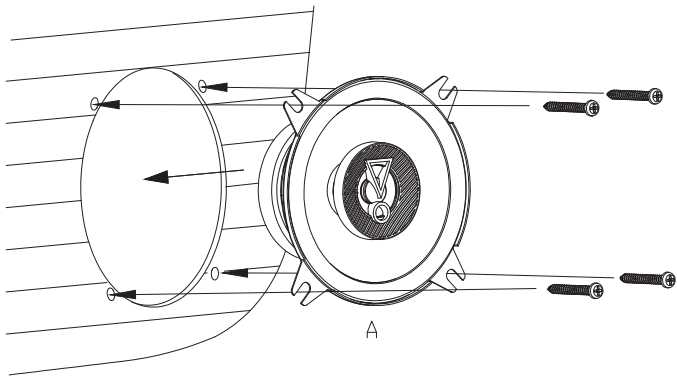

Spécifications

- Type: Haut-parleur de voiture coaxial
2 voies de 100 mm pour optimisation
du système d'origine sans grille
- Tenue en puissance : 30 W RMS, 150 W
maximum
- Sensibilité (à 2,83 V/1 m) : 90 dB
- Réponse en fréquence : 75 Hz – 20 kHz
- Impédance : 3 ohms

Paramètres de Thiele-Small

- BL (Tm): 2.467
- DCR (ohms): 2.74
- Mms (g): 5.501
- Sd (cm²): 63.62
- Cms (µm/N): 0.387
- Vas (l): 2.2146
- Fs (Hz): 109.1
- Qes: 1.698
- Qms: 12.973
- Qts: 1.501
- Crossover Point: 7kHz

STAGE3 527

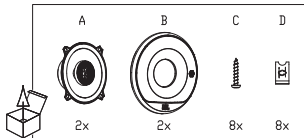
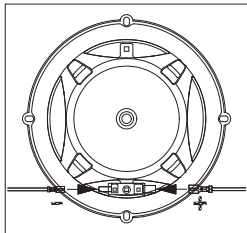
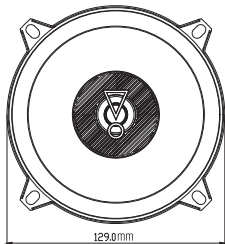
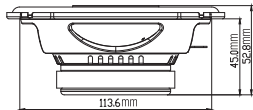

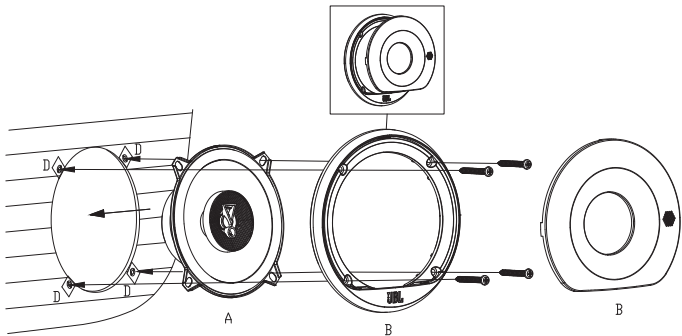

Spécifications

- Type: Haut-parleur de voiture coaxial
2 voies de 130 mm
- Tenue en puissance : 40 W RMS, 200 W maximum
- Sensibilité (à 2,83 V/1 m) : 91 dB
- Réponse en fréquence : 75 Hz – 20 kHz
- Impédance : 3 ohms

Paramètres de Thiele-Small

- BL (Tm): 3.148
- DCR (ohms): 2.61
- Mms (g): 9.81
- Sd (cm²): 102.07
- Cms (µm/N): 0.281
- Vas (l): 4.1374
- Fs (Hz): 95.9
- Qes: 1.555
- Qms: 13.546
- Qts: 1.395
- Crossover Point: 6kHz

STAGE3 527F

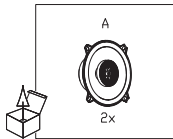
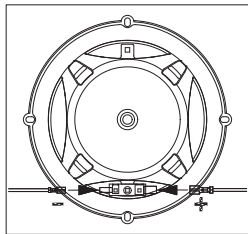
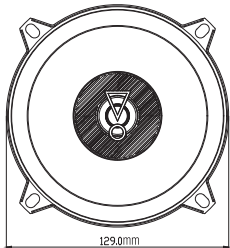
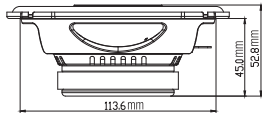

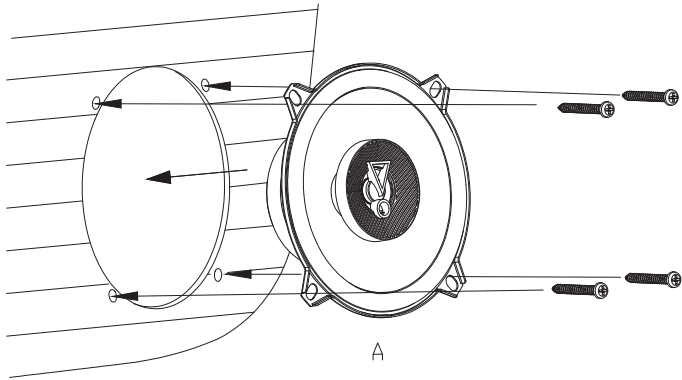

Spécifications

- Type: Haut-parleur de voiture coaxial
2 voies de 130 mm pour optimisation
du système d'origine sans grille
- Tenue en puissance : 40 W RMS, 200 W
maximum
- Sensibilité (à 2,83 V/1 m) : 91 dB
- Réponse en fréquence : 75 Hz – 20 kHz
- Impédance : 3 ohms

Paramètres de Thiele-Small

- BL (Tm): 3.148
- DCR (ohms): 2.61
- Mms (g): 9.81
- Sd (cm²): 102.07
- Cms (µm/N): 0.281
- Vas (l): 4.1374
- Fs (Hz): 95.9
- Qes: 1.555
- Qms: 13.546
- Qts: 1.395
- Crossover Point: 6kHz

STAGE3 627

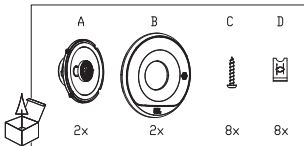
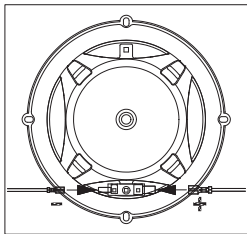
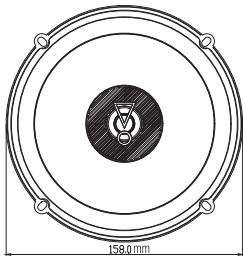
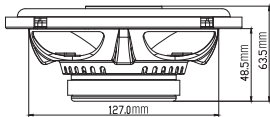

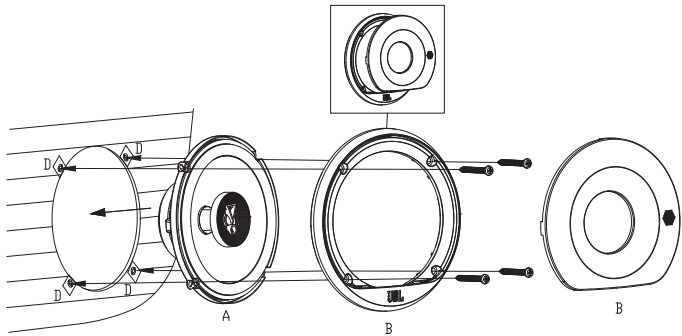

Spécifications

- Type: Haut-parleur de voiture coaxial
2 voies de 160 mm
- Tenue en puissance : 45 W RMS, 225 W maximum
- Sensibilité (à 2,83 V/1 m) : 92 dB
- Réponse en fréquence : 55 Hz – 20 kHz
- Impédance : 3 ohms

Paramètres de Thiele-Small

- BL (Tm): 3.347
- DCR (ohms): 2.43
- Mms (g): 13.661
- Sd (cm²): 138.93
- Cms (µm/N): 0.339
- Vas (l): 9.2635
- Fs (Hz): 73.9
- Qes: 1.377
- Qms: 13.148
- Qts: 1.246
- Crossover Point: 5kHz

STAGE3 627F

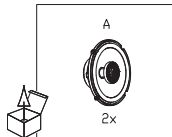
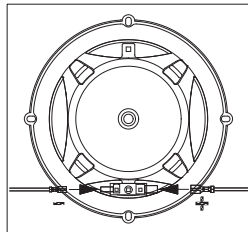
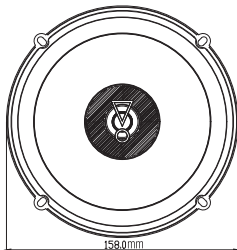
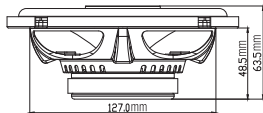

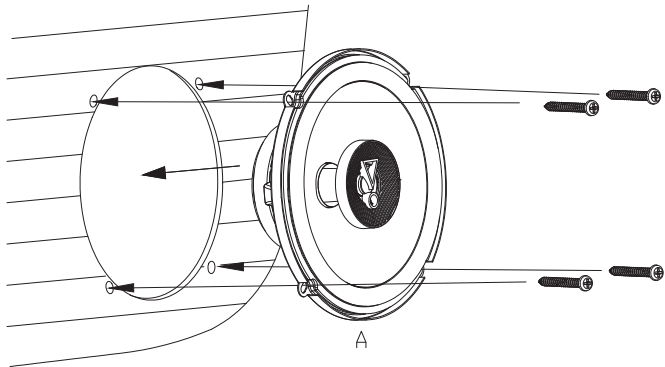

Spécifications

- Type: Haut-parleur de voiture coaxial
2 voies de 160 mm pour optimisation
du système d'origine sans grille
- Tenue en puissance : 45 W RMS, 225 W
maximum
- Sensibilité (à 2,83 V/1 m) : 92 dB
- Réponse en fréquence : 55 Hz – 20 kHz
- Impédance : 3 ohms

Paramètres de Thiele-Small

- BL (Tm): 3.347
- DCR (ohms): 2.43
- Mms (g): 13.661
- Sd (cm²): 138.93
- Cms (µm/N): 0.339
- Vas (l): 9.2635
- Fs (Hz): 73.9
- Qes: 1.377
- Qms: 13.148
- Qts: 1.246
- Crossover Point: 5kHz

STAGE3 637F

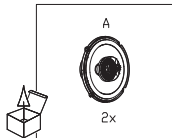
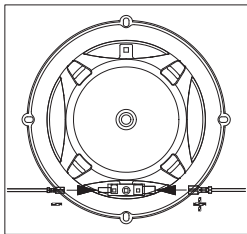
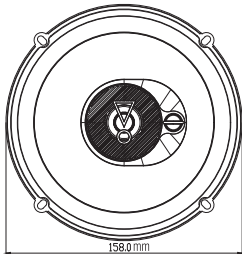
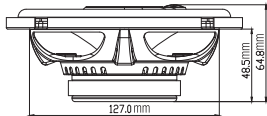

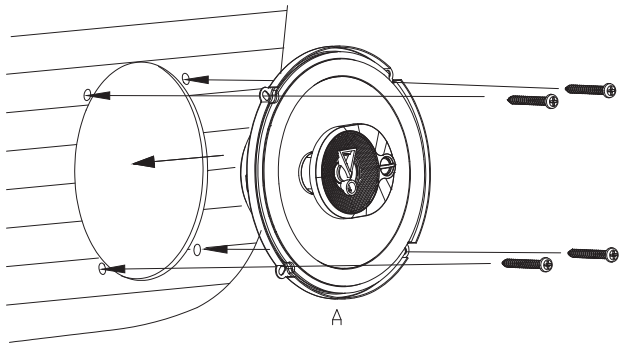

Spécifications

- Type: Haut-parleur de voiture 3 voies de 165 mm pour optimisation du système d'origine sans grille
- Tenue en puissance : 45 W RMS, 225 W maximum
- Sensibilité (à 2,83 V/1 m) : 92 dB
- Réponse en fréquence : 55 Hz – 20 kHz
- Impédance : 3 ohms

Paramètres de Thiele-Small

- BL (Tm): 3.347
- DCR (ohms): 2.43
- Mms (g): 13.661
- Sd (cm²): 138.93
- Cms (µm/N): 0.339
- Vas (l): 9.2635
- Fs (Hz): 73.9
- Qes: 1.377
- Qms: 13.148
- Qts: 1.246
- Crossover Point: 5kHz

STAGE3 6427

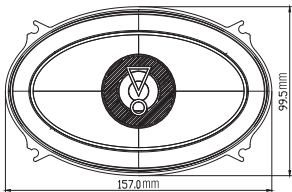
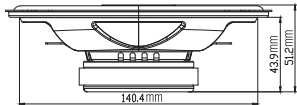

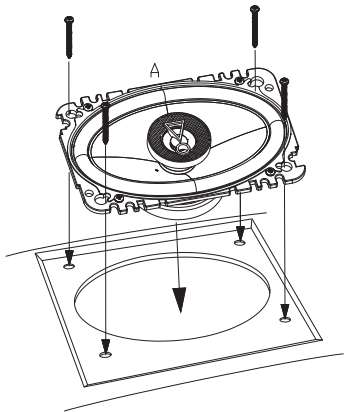
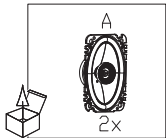
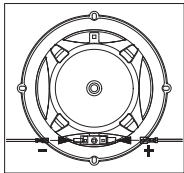

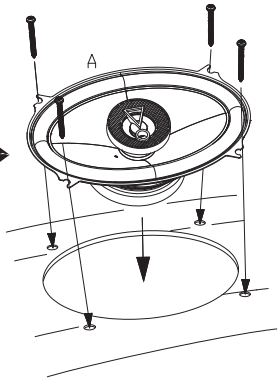
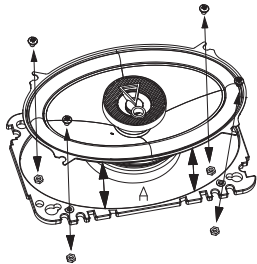

Spécifications

- Type: Haut-parleur de voiture coaxial
2 voies de 100 mm x 152 mm
- Tenue en puissance : 35 W RMS, 175 W maximum
- Sensibilité (à 2,83 V/1 m) : 91 dB
- Réponse en fréquence : 75 Hz – 20 kHz
- Impédance : 3 ohms

Paramètres de Thiele-Small

- BL (Tm): 3.146
- DCR (ohms): 2.36
- Mms (g): 8.151
- Sd (cm²): 86.59
- Cms (µm/N): 0.272
- Vas (l): 2.884
- Fs (Hz): 106.9
- Qes: 1.307
- Qms: 13.178
- Qts: 1.189
- Crossover Point: 6kHz

STAGE3 8627

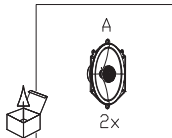
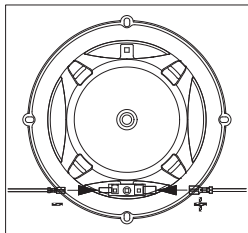
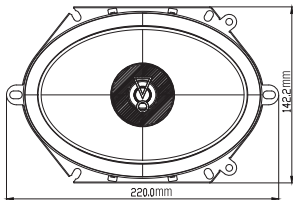
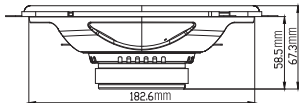

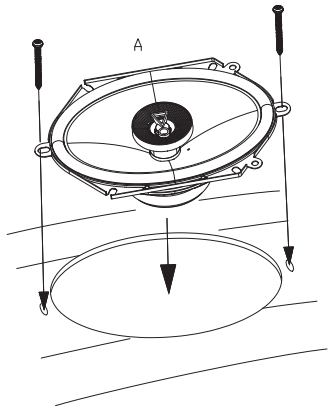
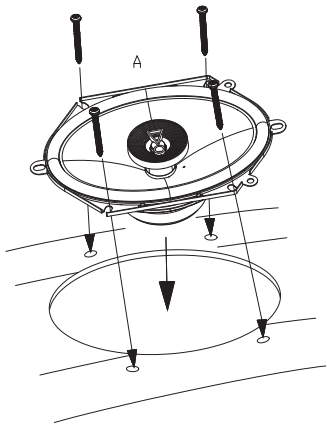

Spécifications

- Type: Haut-parleur de voiture coaxial
2 voies de 152 mm x 203 mm
- Tenue en puissance : 50 W RMS, 250 W maximum
- Sensibilité (à 2,83 V/1 m) : 93 dB
- Réponse en fréquence : 65 Hz – 20 kHz
- Impédance : 3 ohms

Paramètres de Thiele-Small

- BL (Tm): 3.736
- DCR (ohms): 2.63
- Mms (g): 17.369
- Sd (cm²): 176.71
- Cms (µm/N): 0.396
- Vas (l): 7.7316
- Fs (Hz): 60.7
- Qes: 1.25
- Qms: 11.955
- Qts: 1.132
- Crossover Point: 6kHz

STAGE3 9637

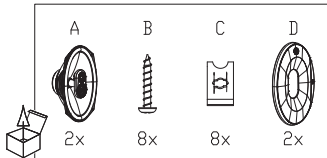
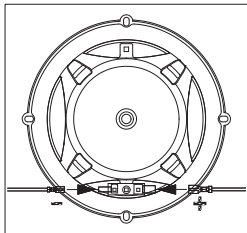
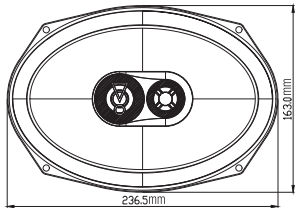
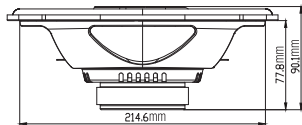

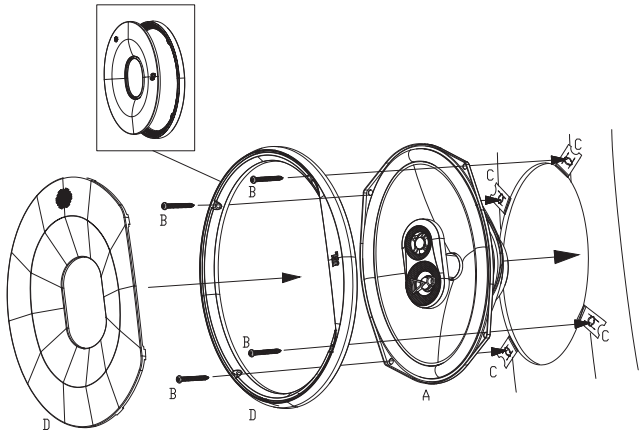

Spécifications

- Type: Haut-parleur de voiture 3 voies de 152 mm x 230 mm
- Tenue en puissance : 75 W RMS, 375 W maximum
- Sensibilité (à 2,83 V/1 m) : 93 dB
- Réponse en fréquence : 50 Hz – 20 kHz
- Impédance : 3 ohms

Paramètres de Thiele-Small

- BL (Tm): 3.533
- DCR (ohms): 2.34
- Mms (g): 22.973
- Sd (cm²): 237.79
- Cms (µm/N): 0.404
- Vas (l): 32.3563
- Fs (Hz): 52.2
- Qes: 1.413
- Qms: 13.661
- Qts: 1.281
- Crossover Point: 5kHz

STAGE3 9637F

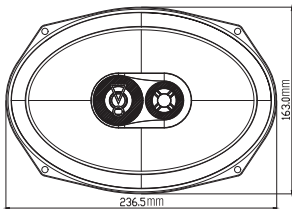
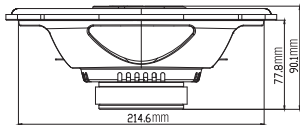

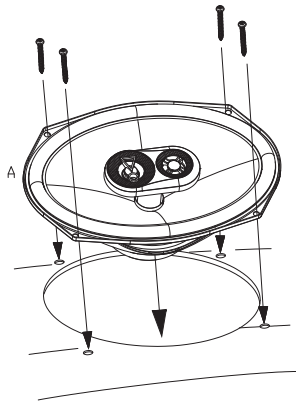
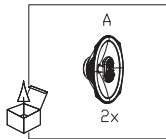
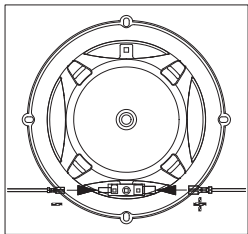

Spécifications

- Type: Haut-parleur de voiture 3 voies de 152 mm x 230 mm pour optimisation du système d'origine sans grille
- Tenue en puissance : 75 W RMS, 375 W maximum
- Sensibilité (à 2,83 V/1 m) : 93 dB
- Réponse en fréquence : 50 Hz – 20 kHz
- Impédance : 3 ohms

Paramètres de Thiele-Small

- BL (Tm): 3.533
- DCR (ohms): 2.34
- Mms (g): 22.973
- Sd (cm²): 237.79
- Cms (µm/N): 0.404
- Vas (l): 32.3563
- Fs (Hz): 52.2
- Qes: 1.413
- Qms: 13.661
- Qts: 1.281
- Crossover Point: 5kHz



HARMAN International Industries,
Incorporated

8500 Balboa Boulevard,
Northridge, CA 91329 États-Unis

© 2018 HARMAN International
Industries, Incorporated.

Tous droits réservés.

JBL est une marque de commerce de HARMAN International Industries, Incorporated, déposée aux États-Unis et/ou dans d'autres pays.

Les caractéristiques, les spécifications et l'aspect sont susceptibles d'être modifiés sans préavis.